

INSTALLATION INSTRUCTIONS



TYPE AND APPLICATION

The Omega Toilet Pan Adaptor has been designed for installation with toilet pans.

The large catchment bowl is installed at or below the floor level and includes a centred pipe outlet with acute wall angles which increase fall, improve flow & eliminate backflow.

The large flat top lid provides a wide surface area for aligning and installing plumbing connection. This eliminates issues with tight tolerances in plumbing and trying to line up piping.

FEATURES

- Large catchment bowl for increased flow.
- Designed to prevent backflow in the case of blockages.
- Unique Funnel Ring has an interior edge that prevents the installer from pressing the pipe down too far.
- No more offset fitting required for toilets.
- No need to adjust toilet pan to suit riser pipe.

TECHNICAL DIMENSIONS

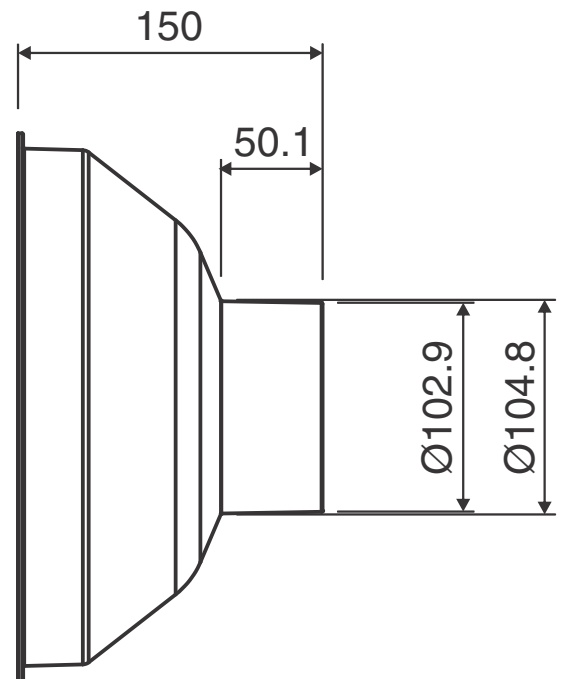
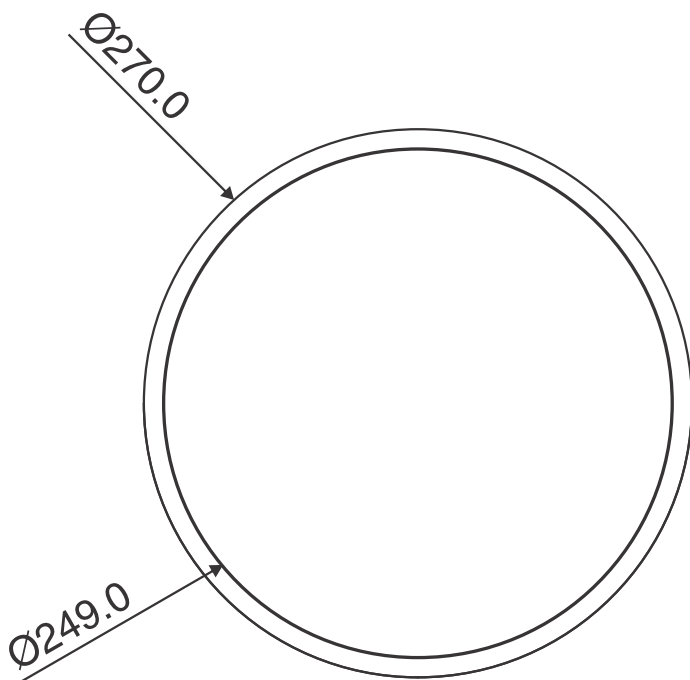



INSTALLATION GUIDELINES

This product must be installed by a qualified professional and in accordance with the manufacturer's installation instructions, municipal building codes, local water supply regulations and any other statutory regulations. The installation of the system must comply with the requirements of the Plumbing Code Australia.

This document is a guide only and does not cover all unforeseen on-site circumstances. The information within this guide is merely designed to assist with the installation of the product.

RECOMMENDATIONS

It is the responsibility of the builder or qualified tradesperson to ensure that all substrates and structures constructed or installed prior to installation of the Omega Toilet Pan Adaptor are compliant with the Australian Standards requirement, building codes and are constructed or installed in accordance to all manufacturers' recommendations.

COMPONENTS PROVIDED

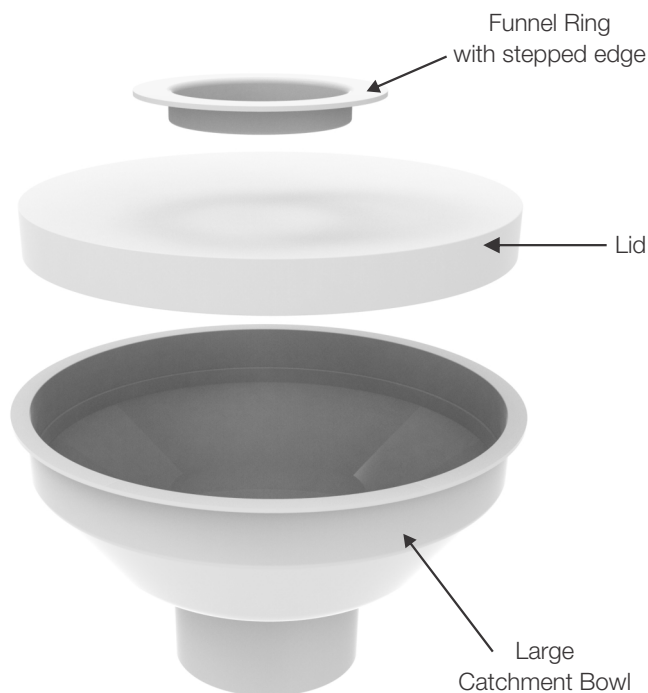

Proudly designed and manufactured in Australia



CONCRETE SLAB INSTALLATION METHOD

- 1) Fix the Lid to the Bowl by applying an even coat of Pipe Priming Fluid (AS3879 compliant) around the outer sides of the Lid and the inner edge of the Bowl. Repeat the process using a liberal coat of ABS Pipe Cement Type P (AS3879 compliant) over the primer.

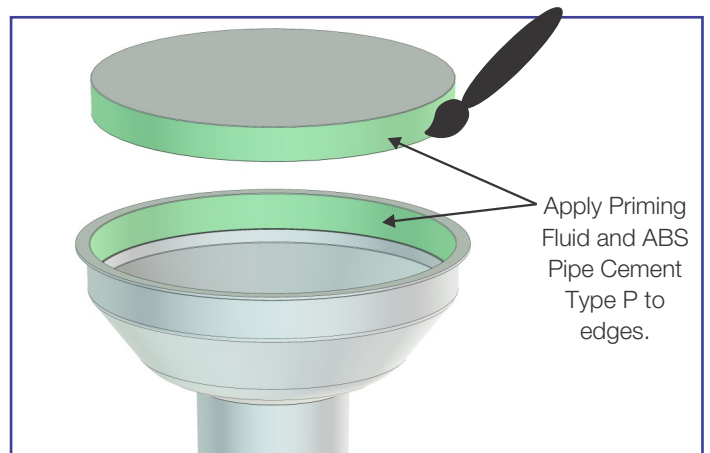

- 2) Push the lid down into the bowl and allow it to cure per the instructions.

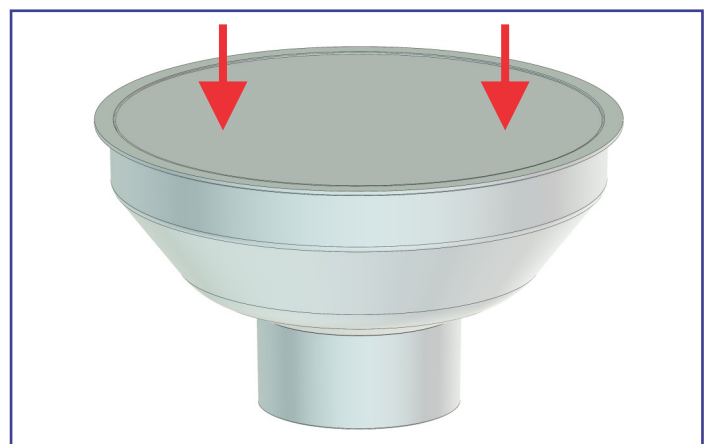

Omega Climate Systems
 1 Abbotts Road, Dandenong South VIC 3175
 Phone: (03) 9706 6884 Email: carin@omegacs.com.au
 www.omegacs.com.au

CONCRETE SLAB INSTALLATION METHOD CONT'D

- 3) Prior to concrete slab pour, fix the Toilet Pan Adaptor into the drainage riser using an even coat of Pipe Priming Fluid (AS3879 compliant) around the outside of the Spigot End and the inner edge of the Riser. Repeat the process using a liberal coat of PVC Pipe Cement Type P (AS3879 compliant) over the primer.

Ensure the Toilet Pan Adaptor is installed at the correct height, as per the building plans, to sit flush with the top surface of the concrete slab.

Allow for adequate curing time as per plumbing primer and cement product instructions.

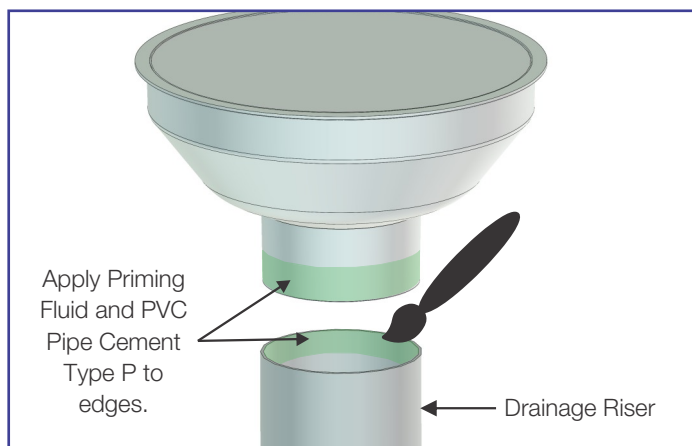

- 4) Once the concrete slab pour has been completed, check to ensure that the Toilet Pan Adaptor has remained at the correct installation height and is within all tolerances. Ideally it should be level and flush with the surface of the concrete slab. Slightly below the surface is also acceptable as long as it is level.

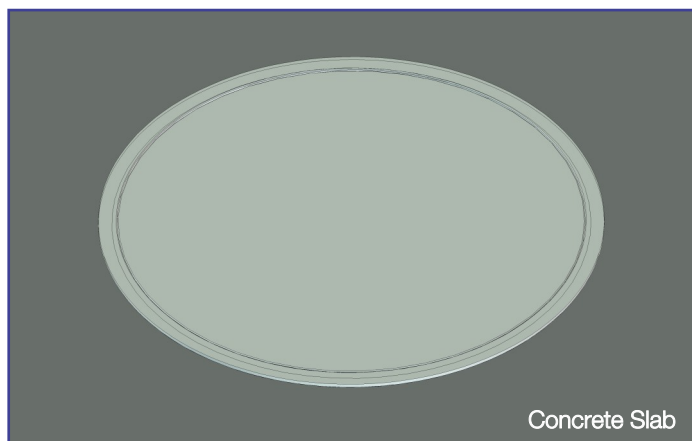

FITTING THE FUNNEL RING

- 1) Measure the centrepoint to make sure that the funnel will sit within the edges of the pan once the hole is drilled. Drill the hole for the funnel using a Ø118mm (4-5/8") holesaw.

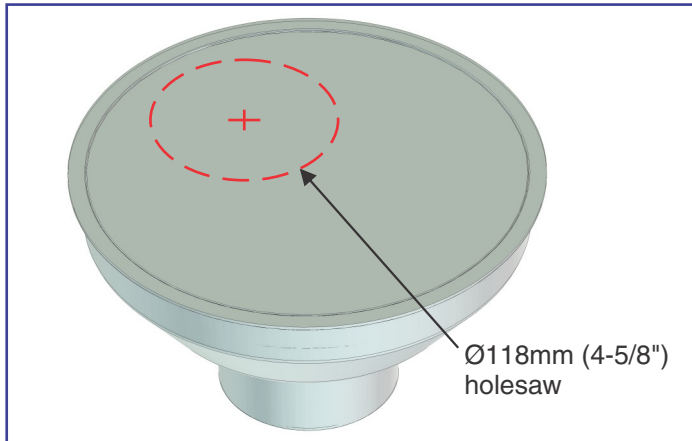

- 2) To fix the Funnel Ring to the Lid apply an even coat of Pipe Priming Fluid (AS3879 compliant) around the underside edge & sides of the ring. Repeat the process using a liberal coat of ABS Pipe Cement Type P (AS3879 compliant) over the primer. Place it through the hole created in the lid. Push down to create an even seal. Allow for adequate curing time as per the product instructions.



- 3) The interior stepped edge of the funnel allows the pipe to feed down only 17mm where it comes to a stop. This prevents the pipe being pushed down too far & causing a blockage from poor installation.

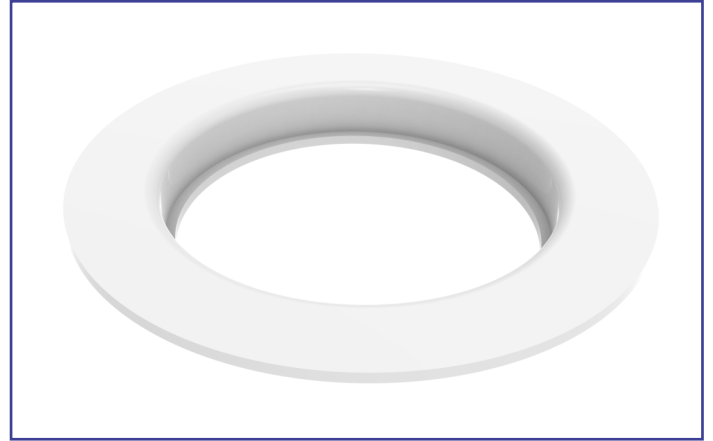

- 4) To finish, adhere the product piping to the inner wall of the Funnel Ring using a suitable sealant method according to guidelines from the manufacturer's instructions.

